

(1) Type Examination Certificate

- (2) No. of the Type Examination Certificate: **ZP/B005/14 R1**
- (3) Product: **Anchor device type A**
Type: ABS-Lock® LOOP
- (4) Manufacturer: **ABS Safety GmbH**
- (5) Address: **Gewerbering 3, 47623 Kevelaer, Germany**
- (6) The design of this product and any acceptable variation thereto are specified in the schedule to this type examination certificate.
- (7) The certification body of DEKRA EXAM GmbH certifies that this product comply with the fundamental requirements of the standard listed under item 8 below. The examination and test results in the test and assessment report PB 14-010.
- (8) The requirements of the standard are assured by compliance with
DIN EN 795:2012 **DIN CEN/TS 16415:2013**
- (9) This Type Examination Certificate relates only to the design, examination and tests of the specified product in accordance to the standard list. Further requirements of the Directive apply to the manufacturing process and supply of this personal protective equipment. These are not covered by this certificate.
- (10) This Type Test Certificate is valid until 2019-01-23.

DEKRA EXAM GmbH
Bochum, 2015-08-06

signed: Simanski
Certification body

signed: Mühlenbruch
Special services unit

We confirm the correctness of the translation from the German original. In the case of arbitration only the German wording shall be valid and binding.

Bochum, 2015-08-06
DEKRA EXAM GmbH

Certification body

Special services unit

- (11) Appendix to
- (12) **Type Examination Certificate**
ZP/B005/14 R1
- (13) 13.1 Subject and Type
Anchor device type A
Type: ABS-Lock® LOOP

13.2 Description

The anchor device type: ABS-Lock® LOOP (Figure 1) secures not more than 3 persons against fall from a height. The anchor device is made of corrosion-resistant steel wire of Ø 5 mm diameter and its total length is 504 mm. Both ends of the wire rope are pressed into loops. One loop is fastened to the building structure and is 142 mm long. The user's personal protective equipment against fall from a height can be attached to the other loop (123 mm long).

The anchor device is mounted to the building structure by the larger of the two loops and a mounting bracket (t = 3 mm) as shown in Figure 2. The fastening elements are chosen as required for the surface of the building structure.

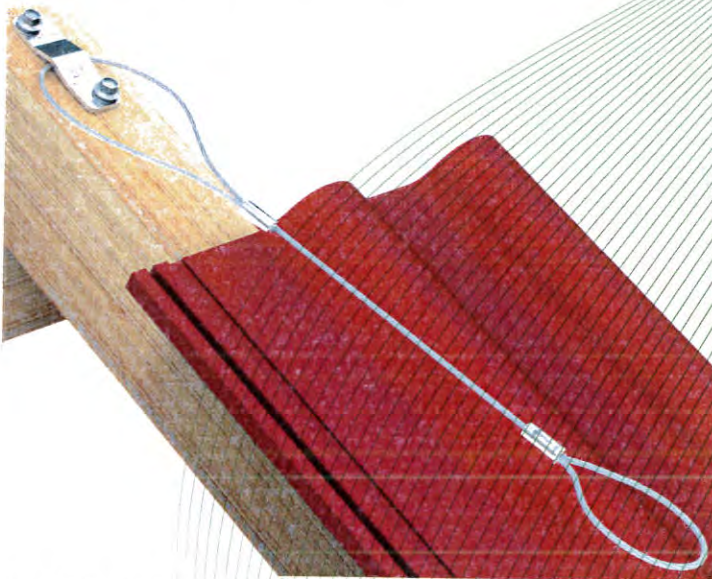

Figure 1: Anchor device type: ABS-Lock® LOOP

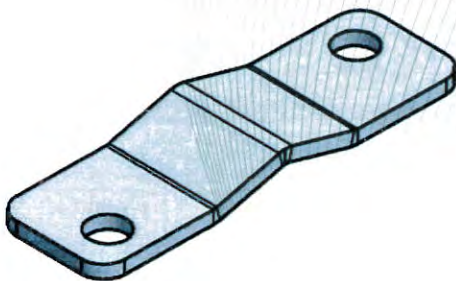

Figure 2: Mounting bracket for anchor device

- (14) Test and Assessment Report

PB 14-010 Revision_01, 2015-08-06